

Pacific Northwest, Canada & North America  
48° 33' N 122° 56' W

## Exploring British Columbia and the San Juan Islands

Discover the pristine wilderness, First Nations history, and seaside communities of the Pacific Northwest. Trace the coast from Seattle to British Columbia to explore isolated coves and archipelagos by kayak and Zodiac, and venture ashore to hike through misty forests. Explore among lush Islands, keeping an eye out for marine mammals and bald eagles; visit picturesque coastal towns; and learn about the native cultures that call this region home.

From  
**\$ 5,061** / per person  
Does not include flights



### DATES

Oct



### DURATION

8 Days



### SHIPS

*National Geographic Venture*



### STARTS AT

Seattle,  
Washington



### ENDS AT

Seattle,  
Washington

## Highlights

- ★ Explore remote islands by kayak or on foot, watching for sea lions, river otters, bald eagles, and white-sided dolphins
- ★ Glide into the sheltered waters of Desolation Sound, discovering its natural beauty by Zodiac, kayak, or paddleboard
- ★ Visit a cultural center in Alert Bay to see a collection of potlatch masks created by the Kwakwaka'wakw people
- ★ Search for humpbacks and orcas in British Columbia, and learn about local populations from a researcher for the Center for Whale Research





## Day by day

### ■ DAY 1

#### Seattle / Embark Ship

Arrive in Seattle, Washington state's largest city, and embark *National Geographic Quest* or *National Geographic Venture*.

**Arrival time:** Arrive by 2:00 p.m. local time.

**Arrival city:** Seattle, WA

**Meals included:** dinner

### ◇ DAY 2

#### Victoria, British Columbia

Clear into Canada in the charming city of Victoria and choose from several tailor-made options to explore based on your interests. Visit private gardens, bike along the waterfront, stroll through Old Town or peruse the collections at local art galleries. In the evening, enjoy a private reception at the Art Gallery of Greater Victoria while taking in their wide-ranging collection.

**Meals included:** breakfast, lunch, dinner

### ◇ DAY 3

#### Desolation Sound

Desolation Sound, on the north end of British Columbia's Sunshine Coast, is a mecca for kayakers and small yachts. It's easy to understand why, with its calm, sheltered waters and outstanding natural beauty. By kayak there are many isolated bays to poke into and islets that beckon for exploration. On land there are meadows and forest trails for hiking.

**Meals included:** breakfast, lunch, dinner

### ◇ DAY 4

#### Johnstone Strait / Alert Bay

Sail through Johnstone Strait, a waterway cut through a magnificently wild and scenic area of mountains and islands. These ocean waters are also home to extraordinary marine mammals and bird watching. Today, visit one of the oldest First Nations village sites in British Columbia. Alert Bay on Cormorant Island has been, and continues to be, the home of the Kwakwaka'wakw people and a center for the living culture found throughout the Northwest Coast. Visit the U'Mista Cultural Centre, which houses one of the northwest coast's finest collections of elaborately carved potlatch masks, regalia and coppers. Then, visit the Big House a short distance away where the T'sasala Cultural Group continues the sharing of culture, "educating the world about their songs, dances, teachings and values."

**Meals included:** breakfast, lunch, dinner

### ◇ DAY 5

#### Exploring the Gulf Islands

Wake this morning among the Gulf Islands, a rich archipelago in the Strait of Georgia, and a yachter's paradise. Take your pick of perfect spots to kayak, hike and search for wildlife.

**Meals included:** breakfast, lunch, dinner

### ◇ DAY 6

#### Friday Harbor

Explore Friday Harbor, a picturesque town on San Juan Island. Visit the Whale Museum, with its fascinating collection of artifacts, artwork and whale skeletons. Stop in at small shops and galleries.

**Meals included:** breakfast, lunch, dinner

### ◇ DAY 7

#### Exploring the San Juan Islands

Visit the more remote of the San Juan Islands, an archipelago in northern Washington State perfect for kayaking, exploring by Zodiac and hiking. Walks with your expert staff will familiarize you with the natural and cultural history of the rugged northwest coast region. Tonight, enjoy the Captain's farewell dinner.

Meals included: breakfast, lunch, dinner

## ■ DAY 8

### Seattle / Disembark Ship

Disembark *National Geographic Venture* and transfer to the airport for flights home.

**Departure time:** Depart after 11:30 a.m. local time.

**Departure city:** Seattle, WA

Meals included: breakfast

**Expedition**

Seattle, Washington → Seattle, Washington

**2026 Departure Dates**

Aboard *National Geographic Venture*

03 Oct	10 Oct	17 Oct		
--------	--------	--------	--	--

**2027 Departure Dates**

Aboard *National Geographic Venture*

09 Oct	16 Oct		
--------	--------	--	--



## ***National Geographic Venture***

---

**Guests**

100

**Cabins**

50

---

**The *National Geographic Venture* is a state-of-the-art expedition ship ideal for discovering remote locations in domestic waters.**

Following the build of *National Geographic Quest* at Nichols Brothers shipyard, her sister ship the 100 guest *National Geographic Venture* floated into the bay on Whidbey Island, becoming the 4th ship in the Lindblad fleet built at this storied PNW shipyard. In the 1970s, Nichols Brothers built the twin ships *National Geographic Sea Bird* and *National Geographic Sea Lion*, which continue to sail the waters of the west coast of North America and Central America.

*Venture*, like much of the wildlife she follows, is migratory. She follows the seasons from Alaska, along the coast of British Columbia, up the Columbia & Snake Rivers, and along the Baja coast and into the Sea of Cortez. In each region, her design innovations were informed by 50+ years of expedition expertise to ensure extraordinary discoveries. Larger than her sibling twin ships, *National Geographic Sea Bird* and *National Geographic Sea Lion*, *National Geographic Venture* has the same shallow draft, enabling her to nimbly navigate the same inner reaches and provide the same intimate, 'insider' experiences of the charismatic regions we explore.

Like her sister ship *National Geographic Quest*, *National Geographic Venture* has dual boarding platforms, enabling our team to load two Zodiacs at once means guests get off ship quickly, to take advantage of wildlife sightings and maximize exploring time. Modern, cleaned-lined, with large expanses of glass to keep you connected to the extraordinary views, *National Geographic Venture* enables you to see, do and experience the best of her geographies.



# Cabin Categories

## Category 1

**Main Deck: #301-306**

Cabins feature two single beds that can convert to a Queen, a writing desk, two nightstands and two portholes, full length mirror, and reading lights.



## Category 2

**Main Deck: #307-315**

Cabins feature two single beds that can convert to a Queen, a writing desk, two nightstands and two portholes, full length mirror, and reading lights.



## Category 3

**Upper Deck: #201-206**

Cabins feature two single beds that can convert to a Queen, a writing desk, two nightstands, a large view window, full-length mirror, and reading lights.



## Category 4

**Upper Deck: #207-229**

Cabins feature two single beds that can convert to a Queen, a writing desk, closet, two nightstands, full-length mirror, reading lights, sliding glass door, and a small, private balcony.



**Note:** Solo occupancy cabins are available in Categories 1 and 2 only. Third person rates are available in Category 5 cabins at one half the double occupancy rate.

### Connecting Cabins via internal doorway access:

Main Deck: #312-314, #311-315, #306-307;  
Upper Deck: #224-226, #225-227

## Category 5

### Observation Deck: #101-108 (SUITE)

Cabins feature two single beds that can convert to a Queen, large view windows, closet, two nightstands, full-length mirror, reading lights, a suite-sized expanded bathroom, writing desk, ample storage space, and a convertible sofa bed to accommodate a third person.



## Observation Deck

Category 5

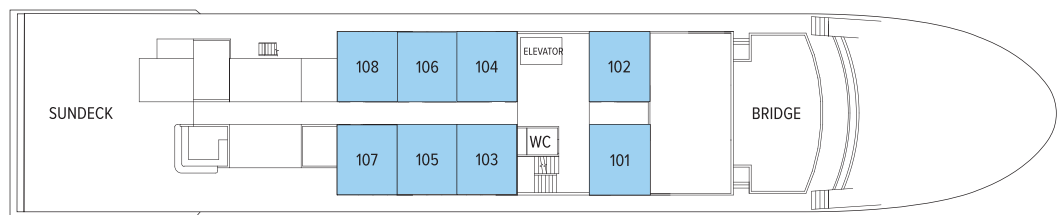

## Lounge Deck

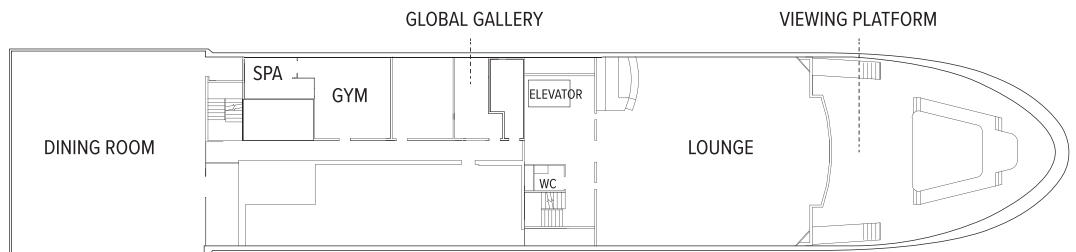

## Upper Deck

Category 3

Category 4

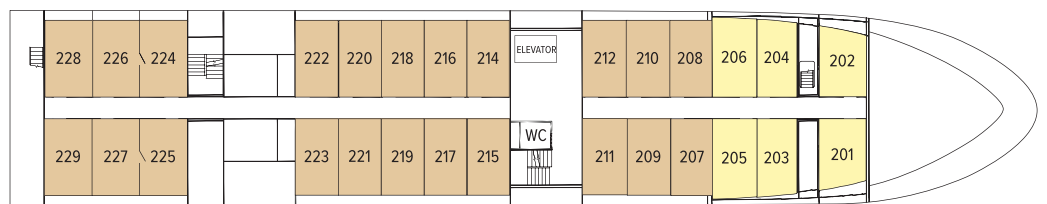

## Main Deck

Category 1

Category 2

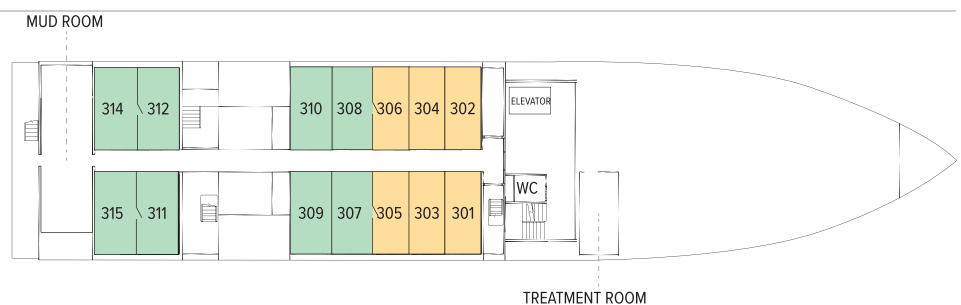

# Ship amenities

## Public Areas

Reception; main dining area; global gallery; fitness center; lounge with full-service bar and state-of-the-art presentation facilities; observation deck; mudroom with lockers for expedition gear; partially-covered furnished sundeck; plus open access to the Bridge, the Captain, officers and on-duty wildlife spotters.

## Meals

Meals are served in the dining room at a single seating with unassigned tables for an informal atmosphere and easy mingling. Menus feature sustainable choices, local where possible.

## Cabins

50 outside cabins. All cabins face outside with windows, private bathroom, and climate controls. Cabins are equipped with Wi-Fi, phone, multiple electrical and USB outlets, and phones. Luxury linens and pillows. Botanically inspired shampoo, conditioner, shower gel, and lotion are all available in cabin bathrooms, as well as an Expedition Essential Kit. Hair dryers, complimentary insulated water bottles and a National Geographic Atlas are also available in each cabin.

## Expedition Equipment

A fleet of 8 Zodiacs, 24 kayaks, paddleboards; an ROV, hydrophone, splash-cam, underwater video camera, video microscope; snorkeling gear and wet suits for all guests (where applicable).

## Special Features

Lindblad-National Geographic certified photo instructor, undersea specialist and video chronicler. Internet access. Elevator. The design of the outside decks—with the perfect wildlife viewing platform. And the way the proximity of the Lounge to the deck gives you instant access to spontaneous sightings. Have your camera ready!

## Wellness

A fitness center with elliptical, treadmill, weights, resistance bands; LEXspa treatment room, staffed by wellness specialists.



## Self-Disinfecting Ships

ACT Clean Coat™ is a light-activated, self-disinfecting cleaning process that continuously breaks down viruses, bacteria, mold, and airborne allergens across all ship surfaces. Not only does this create a cleaner, healthier shipboard environment for guests and crew alike, but this non-toxic, chemical-free system also saves more than one million gallons of water each year in our cleaning procedures, and reduces our carbon footprint as well as the amount of plastic and waste in our supply chain.

## Special Offers

### 10% SAVINGS

Valid on new bookings made between July 15 through July 29, 2025. Receive savings of 10% from the cabin fare on select 2027-2028 departures. Valid on all departures starting March 27, 2027 aboard National Geographic Resolution; April 2, 2027 aboard National Geographic Delfina, National Geographic Endeavour II and National Geographic Islander II; April 3, 2027 aboard National Geographic Gemini; April 7, 2027 aboard National Geographic Orion; April 26, 2027 aboard National Geographic Venture; May 2, 2027 aboard National Geographic Quest; and November 19, 2027 aboard National Geographic Explorer. Not combinable with other promotional offers, subject to availability, not applicable on airfare or extensions. Book online or call for details.

### SUITE EXCLUSIVES

Spacious living areas and incredible views immerse you in the beauty of your marine surroundings. Our new Suite Exclusives package helps make your voyage all the more memorable. [Learn more](#)

### CELEBRATE LIFE'S MILESTONES

Celebrate a milestone with a group of eight or more and enjoy a special amenity package including: 5% savings on voyage fares, custom group photo, US\$150 shipboard credit for the group, and other special gifts. Milestone celebration to be communicated at time of booking.

### SAVE 5% TRAVELING AS A GROUP

Save 5% when traveling as a group of eight or more people. Valid on voyage fares only and not applicable on extensions or airfare. Deposit, final payments, and

cancellation policies for group travel vary from our regular policies. Valid for new bookings only, subject to availability, and may not be combined with other offers. Call for details.

### PAY BY DEBIT: EARN A \$100 ONBOARD CREDIT

The \$100 onboard credit offer is applied after the final payment and requires 85% of the cost of the voyage to be placed on a debit card. Maximum of one \$100 onboard credit per cabin. The \$100 onboard credit is a non-refundable, non-transferable credit that can be used for various onboard purchases such as global gallery and spa treatments. It has no cash value, cannot be refunded if not fully utilized, and will be forfeited if not fully redeemed by the end of the voyage. This offer is combinable with other offers. If the booking is altered or canceled, the onboard credit may be forfeited, and it cannot be transferred if the booking is moved to another guest. Lindblad Expeditions reserves the right to modify or cancel the offer without prior notice. Offer applies to Lindblad Expeditions' owned ships only. Offer valid only for Debit Cards issued in the United States for payments made from the United States.

### COMBINING OFFERS

Certain offers may be combinable, up to two savings opportunities, except where noted otherwise. For example, travel with a group of 8 or more on back-to-back expeditions, and take advantage of both savings.

## Included in price

All accommodations aboard ship or in hotels per itinerary; all meals as indicated in the itinerary, both aboard and onshore; beer, wine, cocktails, liquors and spirits aboard the ship (except certain premium brands which are available for purchase); hors d'oeuvres, 24-hour access to snacks, premium coffees and teas, non-alcoholic beverages, and filtered water; excursions and airport transfers to and from recommended flights, as indicated in the itinerary; exploration tools curated to destination, such as Zodiacs, stand-up paddleboards, kayaks; guidance and company of our leading expedition staff; assistance by the Lindblad Expeditions-National Geographic certified photo instructor; access to the OM System Photo Gear Locker; presentations by expedition staff and expert guest speakers; complimentary reusable water bottle; onboard physician consultations; morning stretch classes and 24-hour access to exercise equipment; 24-hour access to lounges, observation decks, library, and other shared spaces; basic WiFi, park and site entrance fees, special access permits, and port taxes. Unused services or items included in our programs are non-refundable.

## Not included in price

Airfare (except flights\* when indicated as included); pre- and post-expedition extensions; additional hotel nights (except when indicated as included); crew gratuities; private transfers; laundry, spa treatments, travel protection plans; and passport, visa, and immigration fees.

\*Recommended flight costs include flight(s) that take place during the date range of your trip to transport travelers from one itinerary destination to another. This cost also includes ground transportation, luggage transfer, and airport assistance. If you prefer to arrange your own flights privately, have alternate means of transport, or wish to modify at a later time, please contact an Expedition Specialist at 1.833.400.0831

Additional costs associated with medical services outside onboard physician consultation.

coverage to protect you from cancellation fees, costs incurred due to trip delays/interruption, damage or loss of baggage, medical assistance, and evacuation during your travels. Our Travel Protection Plan is available for U.S. residents only, and may be purchased any time prior to final payment due date, Travel Protection premiums are non-refundable once plan is purchased. Learn more about our Travel Protection "Plus" Plan: <https://www.expeditions.com/terms-conditions/travel-protection-plan/>

## Cancellation policy

Review our cancellation policy: <https://www.expeditions.com/cancellation-policy/>

## Travel protection plan

We strongly recommend our guests to take advantage of our Travel Protection Plan. This plan offers comprehensive